





of the 1990s, and the 1990s have been a period of rapid growth in the number of people who are taking part in the study. The study is now the largest of its kind in the world, with over 100,000 people taking part in the study. The study is now the largest of its kind in the world, with over 100,000 people taking part in the study. The study is now the largest of its kind in the world, with over 100,000 people taking part in the study.

[illegible]

**SKBM (SK Battery Manufacturing Plant)**

1



**HYUNDAI**  
ENGINEERING CO., LTD.

Responsible Designer  
Kaiser Mottley #11 08-0033

Copyright © 2001 by John Wiley & Sons, Inc.

.....

## Execution design

Architecture

ig Name

Ground floor - Tűzvédelmi  
terv földszint

date:	1:500   421	Drawing No.	ED_ARC_B02_0201_R12
date:	2020.07.07.	date:	

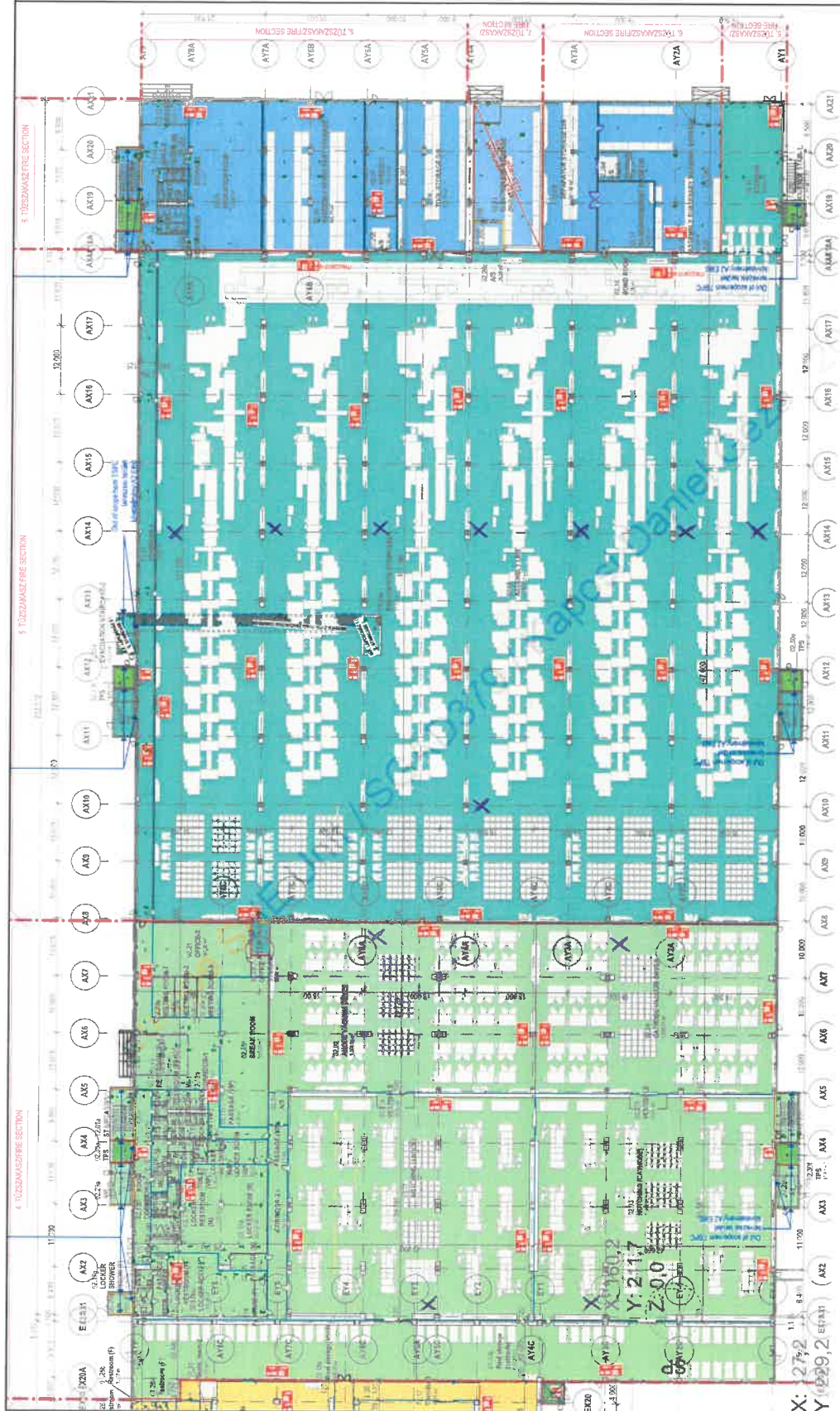











Fire compartment No.	Fire compartment ground floor - Tűzterület [m <sup>2</sup> ]	Area - Terület [m <sup>2</sup> ]
101. Fire section / Tűzterület	10,93 <sup>00</sup>	
104. Fire section / Tűzterület	15 002,74 <sup>00</sup>	
105. Fire section / Tűzterület	208 006,00 <sup>00</sup>	
106. Fire section / Tűzterület	4 540,30 <sup>00</sup>	
107. Fire section / Tűzterület	570,05 <sup>00</sup>	
108. Fire section / Tűzterület	25,50	
109. Fire section / Tűzterület	27,81 <sup>00</sup>	
110. Fire section / Tűzterület	29,83 <sup>00</sup>	
111. Fire section / Tűzterület	29,83 <sup>00</sup>	
112. Fire section / Tűzterület	30,10 <sup>00</sup>	
113. Fire section / Tűzterület	29,83 <sup>00</sup>	
114. Fire section / Tűzterület	55,97 <sup>00</sup>	
NA		

access control system is applied the accessibility of escape routes has to be ensured. The controls and devices providing the opening of exit doors in case of emergency situations should be installed.



manatikus átadályozó befolyás rendszer  
hisz mának a sefin bizni ismell a manatikus  
zámly részre a befolyási ponton a  
ésszem nem ártatást, az ésszem  
zússzes vezérlés, szűrés és  
szűrés (szűrés) szűrés és

[illegible]

**WALLS - PALUK**

	A2 EI 60
	A2 EI 60 (Fire separation)
	A2 EI 30
	A2 EI 30 (without door/window)
	A2 EI 120 (Client requirement)
	A1 EI 90
	C EI 15
	A2 EI 45
	A2 EI 15
	A2 EI 60

**OTHERS - SYSTEME**

	Fire separation - Terrace/wall
	Roof of terrace - Mechanical curial

[illegible]



the 1990s, the number of people with AIDS in the United States has increased from 100,000 to 300,000. The number of people with AIDS in the United States is expected to reach 1 million by the year 2000. The number of people with AIDS in the United States is expected to reach 1 million by the year 2000. The number of people with AIDS in the United States is expected to reach 1 million by the year 2000.

4113	2020.07.28.
4114	2020.07.21.
4115	2020.07.02.
4116	2020.06.16.
4117	2020.04.27.
4118	2020.04.22.
4119	2020.04.16.
4120	2020.04.16.
4121	2020.03.26.
4122	2020.03.16.
4123	2020.03.05.
4124	2020.02.25.
4125	2020.02.06.
4126	2020.01.14.
4127	2020.01.12.17.

REV	DATE	CONTENTS
PROJECT NAME		
SKBM (SK Battery Manufacturing Plant)		

**SK innovation**

**HYUNDAI**  
ENGINEERING CO., LTD.



**PROMOTERS & ENGINEERS**  
MPC Technology Incorporated  
Punjab Construction Company Pvt. Ltd.  
PCCW Telecommunications Limited  
PCL Infrastructure Development Corporation  
PCL Energy Services International Ltd.  
PCL Chemicals Private Limited  
PCL Petroleum Products Private Limited  
PCL Power Generation Private Limited  
PCL Real Estate Development Private Limited  
PCL Telecommunications Private Limited  
PCL Transport & Logistics Private Limited  
PCL Water & Sewerage Private Limited  
PCL Waste Management Private Limited  
PCL Healthcare Private Limited  
PCL Education Private Limited  
PCL Social Welfare Private Limited  
PCL Sports & Recreation Private Limited  
PCL Entertainment Private Limited  
PCL Media & Communications Private Limited  
PCL Information Technology Private Limited  
PCL Financial Services Private Limited  
PCL Insurance Private Limited  
PCL Banking Private Limited  
PCL Finance Private Limited  
PCL Investment Private Limited  
PCL Holding Private Limited

408 1 800 5-1131	Responsible Designer	Kaiser Aluminum 879 08-0563
	Responsible Designer	

Responsible Designer

### Execution design

Architecture

Company Name	Formation
B03	

Fire protection Ground floor - Tűzvédelmi  
terv földszint

date:	1:500 (A7)	Drawing No.	ED_ARC_B03_0201_R13
file:			

2020.07.28.	Drawn:	Checked:
File Number:		

1000000

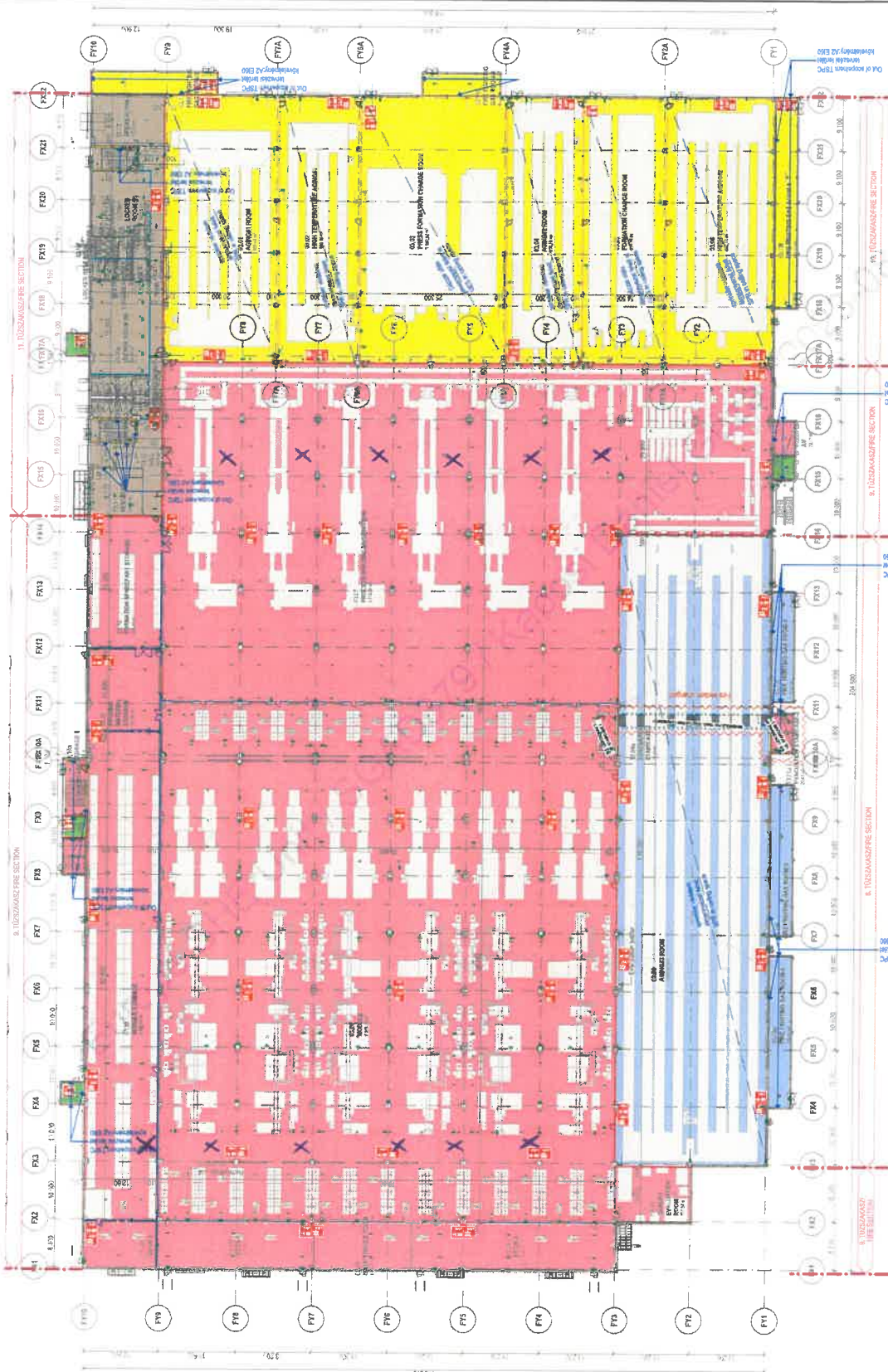

B03 - Fire compartment ground floor - Tőzszakaszok földszint		
Fire compartment No. - Tűzszakasz száma	Area - Terület [m <sup>2</sup> ]	
06. Fire section / Tűzszakasz	8,433,79 <sup>2</sup>	
08. Fire section / Tűzszakasz	30,521,85 <sup>2</sup>	
10. Fire section / Tűzszakasz	30,424,84 <sup>2</sup>	
11. Fire section / Tűzszakasz	1,703,14 <sup>2</sup>	
13B. Fire section / Tűzszakasz	25,12 <sup>2</sup>	
13M. Fire section / Tűzszakasz	25,69 <sup>2</sup>	
13N. Fire section / Tűzszakasz	29,18 <sup>2</sup>	
13Y. Fire section / Tűzszakasz	31,69 <sup>2</sup>	

[illegible]



A detailed floor plan of the first floor of the building. It shows a large central hall with a staircase, several rooms of varying sizes, and a large rectangular area on the right side. The layout is complex, with multiple corridors and doorways connecting the different spaces.

[illegible]

REV.	DATE	CONTENTS
R08	2020.07.10.	
R07	2020.05.16.	
R06	2020.04.23.	
R05	2020.04.18.	
R04	2020.03.31.	
R03	2020.03.19.	
R02	2020.03.05.	
R01	2020.03.03.	
R00	2020.01.28.	

SKBM (SK Battery Manufacturing Plant)

EMPLOYER



CONTRACTOR



ARCHITECT & ENGINEERS  
EPC Technical Supervision and  
Monitoring Consulting Company Kft.  
H-1091 Budapest, Hungary

Temperature Des igner

Business

Personen, die in der Vergangenheit

•

### Execution design

Architects

Model Name

1111

19

Ground floor - Tűzvédelmi  
szint



---

Scale: 1:300 (A2)

[illegible]

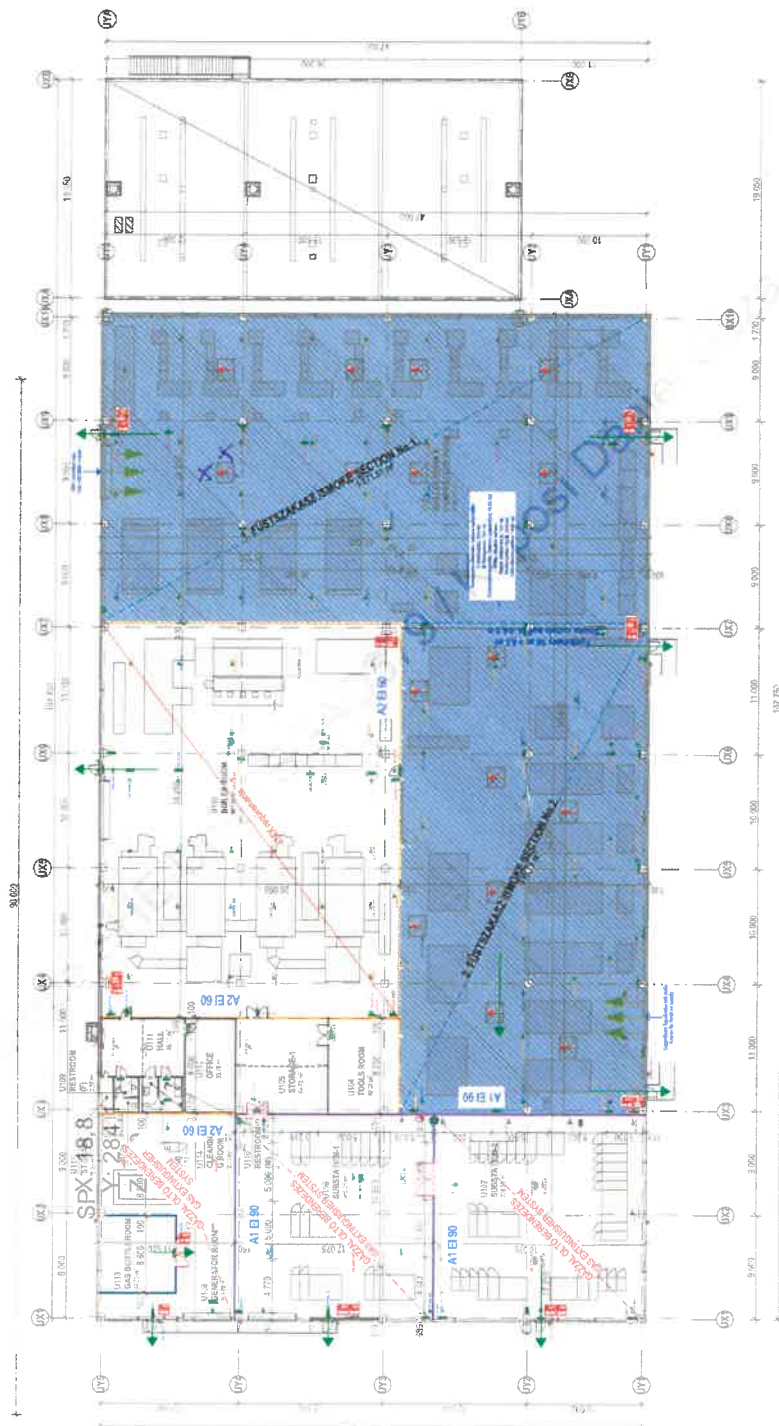
2020.07.15.	Prüfung	Prüfung
-------------	---------	---------



SYMBOLJUEL	SMOKE PARTITIONS • Tűzszakaszok
	Smoke and heat exhaust Hő- és füstelvezetés
	Pressurization system Tűzveszély levezetők
	Means of egress • Menekély útvezető

• **Fire separation:** Fireplaces built  
• **Means of egress:** Identified egress  
• **Means of egress:** Identified egress  
• **Means of egress:** Identified egress

QOR / WINDOW / GATE - NYILÁSZÁRÓK

**TYMERS - EGYEBEK**

	stand pipe and fire hose - állócsap
	fire extinguisher - tűzoltó készülék
	heat- and smoke exhaust, manual aspiration hő- és füsttelvezető, kézi felhívás
	key access box - kulcszet
	push bar - öntároló
	clean agent or carbon dioxide fire extinguisher gázoltó és széndioxid

ALLS-FULAK

A2 EI 60

A2 EI 60 (Fire separation)

A2 EI 30

A2 EI 30 (without door/window)

A2 EI 120 (Client requirement)

B11 Fire compartment ground floor - Tűzszakaszok földszál	
Fire compartment No. - Tűzszakasz száma	Area - Terület [m2]
N/A	4 113,75

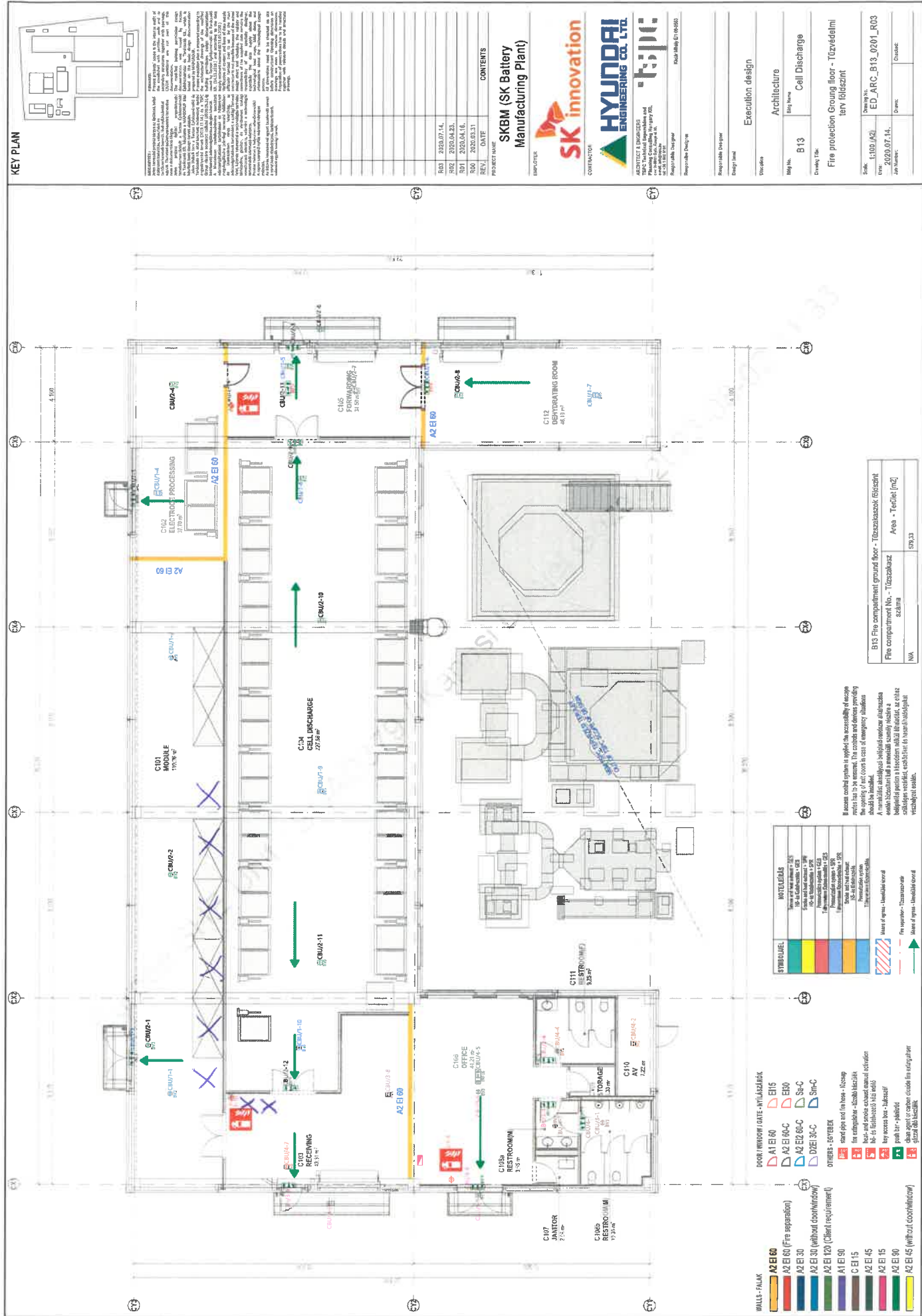

B13 Fire compartment ground floor - Tűzszelektaszok fölsőszint	
Fire compartment No. - Tűzszelektaszok száma	Area - Terület [m2]
N/A	579,33